

ROTFEFELLA MOVE

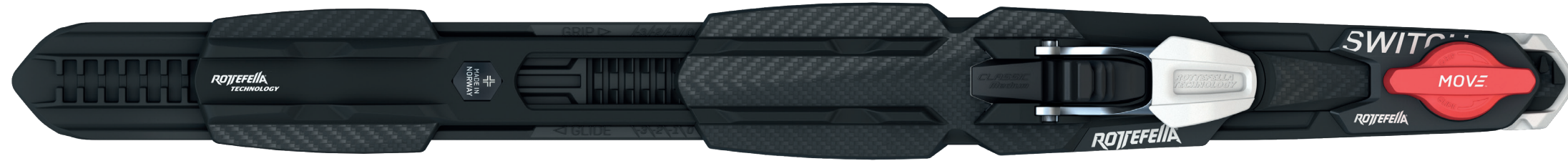

1

Which mounting plate do you have?

Find the mounting plate which you are preparing to mount the MOVE binding on. The diagram below will tell you whether you will need an adapter or not.

2

Do you need an adapter?

Mounting plates without MOVE interface will need an adapter. Choose the right adapter that fits the mounting plate on the skis.

3

Choose a compatible MOVE binding

The MOVE binding consist of a house and a heel. The rail patterns underneath the heels differ and fit either the IFP* mounting plate or all others.

4

Choose a MOVE Unit

There are three MOVE units. Choose MOVE Switch for better grip and glide, choose MOVE Race if you want maximal glide in seconds or choose MOVE Tune for optimal skis in all snow conditions.



NIS 3.0 MOUNTING PLATE
Premounted with MOVE Interface

MADSHUS PELTONEN KASTLE



ROTFEFELLA MOUNTING PLATE
Screw plate with MOVE Interface

SALOMON ATOMIC SKI TRAB



ROTFEFELLA MOUNTING PLATE
Screw plate with MOVE Interface

SALOMON ATOMIC SKI TRAB



NIS 1.0 MOUNTING PLATE
Premounted without MOVE Interface

Premounted on older skis across all major brands.



IFP* MOUNTING PLATE
Premounted without MOVE Interface



RMP MOVE ADAPTER
Art.no bulk: 10200395



NIS 1.0 MOVE ADAPTER
Art.no bulk: 10200397



IFP* MOVE ADAPTER
Art.no bulk: 10200396



MOVE MANUAL NIS/RMP Skate
Art.no bulk: 10200393

MADSHUS PELTONEN KASTLE
SALOMON ATOMIC SKI TRAB



MOVE MANUAL NIS/RMP Classic
Art.no bulk: 10200394

MADSHUS PELTONEN KASTLE
SALOMON ATOMIC SKI TRAB



MOVE MANUAL IFP* Skate
Art.no bulk: 10200391



MOVE MANUAL IFP* Classic
Art.no bulk: 10200392



MOVE SWITCH UNIT
Art.no: 10200389

-24 mm
0 mm
12 mm



MOVE RACE UNIT
Art.no: 10200385

-30 mm
0 mm



MOVE TUNE UNIT
Art.no: 10200390

-30 mm
0 mm
18 mm

Disclaimer – Binding Plate Installation

Rottefella bindings are designed and manufactured to meet the highest standards of performance and safety. At all times must Rottefella's manuals and installation instructions be followed. However, even if Rottefella's manuals and installation instructions are followed, please note that the Rottefella bindings rely on the integrity of the ski plate to which they are mounted. This plate is factory-installed and glued directly onto the ski by the ski manufacturer, not by Rottefella. Please be aware that inadequate bonding of the plate to the ski may compromise the function and safety of the binding. It is vital to ascertain that the ski and plate are in proper condition before mounting a Rottefella binding to the ski. Any concerns regarding the plate installation must be addressed with the ski manufacturer or retailer prior to use. Rottefella assumes no liability and provides no warranty, express or implied, for any malfunction, defect, or performance issue of the binding that is caused by improper installation, adhesion failure by the ski manufacturer, or other defects related to the ski plate, which are not Rottefella's liability.

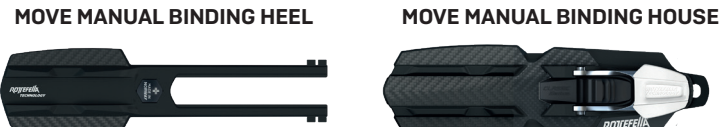

MOUNTING OF ADAPTER

1 PREPARATION OF THE MOUNTING AREA

Use a base cleaner to clean the area in front of the mounting plate where the adapter will go. Push the adapter FLUSH with the mounting plate and mark the area with a pencil.

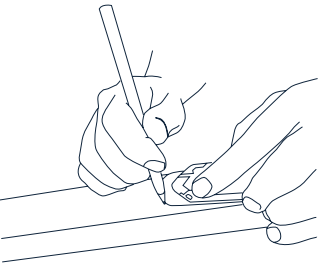

Use the cleaning cloth to clean the area on the skis where the adapter will be fixed. Do not dispose of the cleaning cloth. Use the abrasive pad and rub the surface for 10 seconds. Use the cleaning cloth to remove the dust.

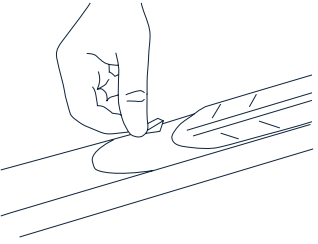

NB! It is important that the surface is completely dry and cleaned for the adapter to be affixed properly.

2 MOUNTING OF ADAPTER

The adapter uses glue that affixes permanently. Before removing the plastic film from the adapter, do a trial fitting first.

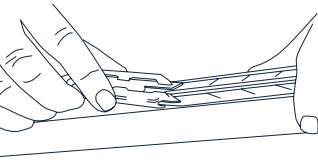

Final assembly: remove the plastic film. Slide the adapter at a slight angle onto the mounting plate WITHOUT the glue touching the ski. Press down for one minute.

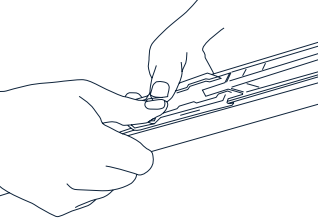

ASSEMBLING THE MOVE BINDING

1 MOUNTING OF BINDING HOUSE AND HEEL

Fit the heel in the binding house at the required shoe size. Turn the heel plate and binding house with the underside up. Press the forks on the heel plate under the tabs on both sides of the binding house and fix them in the right position.

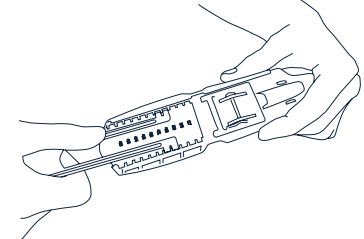

Slide the binding onto the mounting plate, starting from the back. Make sure that the tracks on the underside of the binding grasp the tracks on the sides of the mounting plate. Make sure that the heel plate also grasps the track.

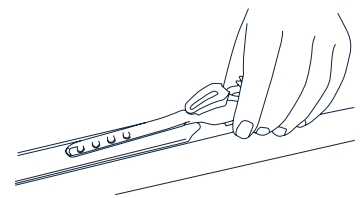

MOUNTING A MOVE UNIT

1 ATTACHING THE MOVE INSERT ON THE BINDING

Hold the binding upside down, take the new insert and place it at a slight angle close to the hole above the small elevation, as shown below. Pull upwards until you hear a click. The binding and insert should be levelled.

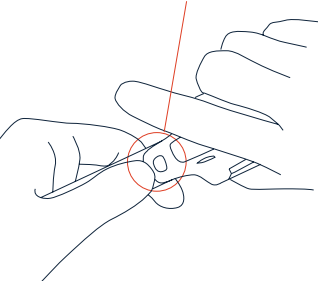

Slide the binding onto the mounting plate, starting from the back. Make sure that the tracks on the underside of the binding grasp the tracks on the sides of the mounting plate. Make sure that the heel plate also grasps the track.

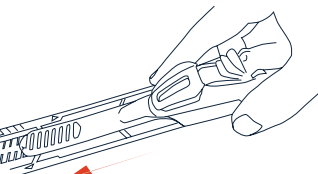

2 ALIGNING THE BINDING ON THE MOUNTING PLATE

Push the binding with the MOVE insert all the way to the top of the adapter.

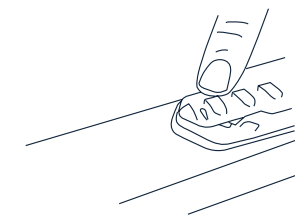

For MOVE Race and MOVE Tune Unit push the binding approx. 5 mm past the tip of the mounting plate. The binding should be aligned with the adapter, as shown in the illustration below.

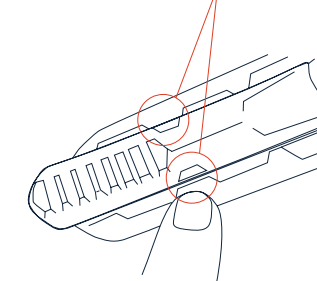

3 LOCKING THE MOVE UNIT IN PLACE

Place the unit in the tracks on the adapter or mounting plate with MOVE interface. If necessary, adjust the binding back and forth a little until the unit fits into place.

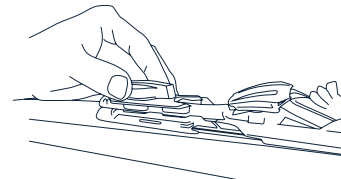

Use the locking pin to lock the unit. It should be pushed all the way to the adapter or mounting plate with MOVE interface.

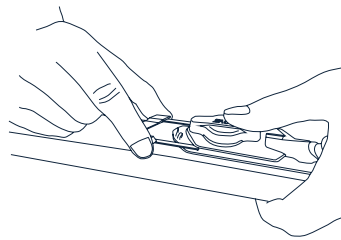

REMOVING AN EXISTING MOVE UNIT

1 UNLOCKING A MOVE UNIT

Remove the locking pin from the existing unit by using an even amount of pressure on both sides of the locking pin while pulling it out of the adapter.

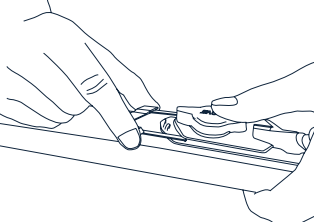

Lift the unit up and keep it in a safe place together with the locking pin for later use.

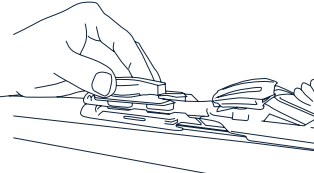

2 REMOVING A MOVE INSERT

If replacing an existing MOVE Unit, slide the binding backwards and off the mounting plate.

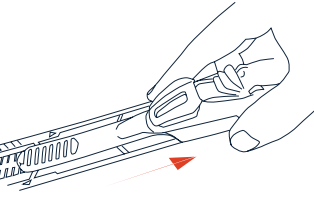

Turn the binding. Detach the existing insert by bending it downwards from the binding. Keep the insert in a safe place together with the unit and locking pin for later use.

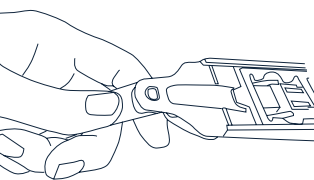

HOW TO USE MOVE RACE MOVE BINDING BACKWARDS

Push the stick to either side to unlock.

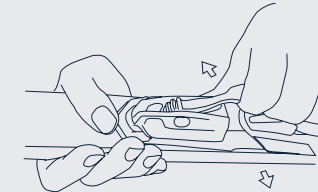

Push the stick forwards; the binding moves 30 mm backwards for maximum glide.

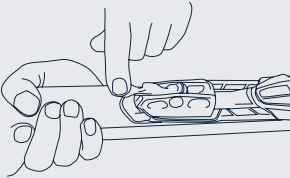

MOVE BINDING FORWARDS

Pull the stick backwards; the binding moves 30 mm forwards.

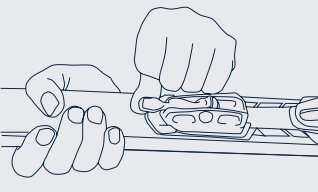

Push the stick down until you hear a click; the binding is now in the starting position. Make sure it is locked in place.

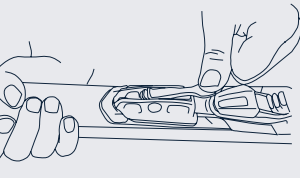

HOW TO USE MOVE SWITCH AND MOVE TUNE MOVE BINDING BACKWARDS

Turn the handle counter clockwise 180° to move the binding backwards. MOVE Switch has 2 positions backwards from start position. MOVE Tune has 9 positions all together.

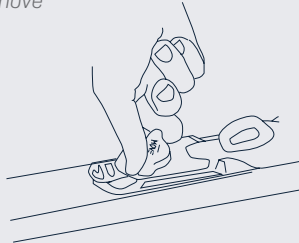

MOVE BINDING FORWARDS

Turn the handle clockwise 180° to move the binding forwards. MOVE Switch has 1 position forwards from start position. MOVE Tune has 9 positions all together.

